

Influenza Specialty Care Unit (ISCU) Planning

The Problem

During an Influenza Pandemic it is assumed most in-patients requiring care will need critical care services. This creates a need for patients that are either unable to care for themselves at home or need some supportive therapy. Massachusetts Department of Public Health has tasked all hospitals to plan for an alternate site for this population of patients.

Aim/Goal

The goal of this project is a plan to care for 80 patients needing low level care in an alternate site, utilizing minimal hospital staff and mostly volunteers.

The Team

- Department of Public Health
- Emmanuel College
- Beth Israel Deaconess Medical Center
- Brigham and Women's Hospital
- Children's Hospital-Boston

The Interventions

- Tool developed to evaluate infrastructure at different sites
- MOA signed from site choice of Emmanuel College Jean Yawkey Center
- Floor plan re-formatted for 160 adult and 40 pediatric patient space
- Workgroups from all three hospitals engaged in planning, clinical operations, Public Safety, Pharmacy etc.

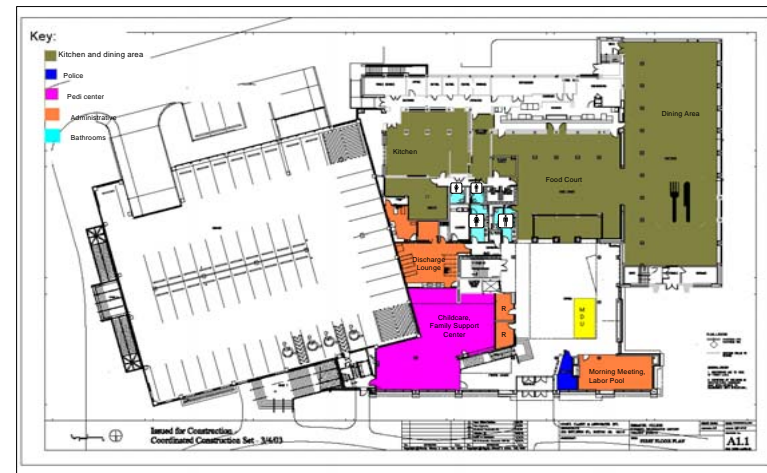

Floor plan for the Jean Yawkey Center to accommodate 160 adult patients.

Lessons Learned

- Licensing is an issue, none of the hospitals hold a dual adult/pediatric license
- Management of an alternate site with altered standards of care will be an issue
- Staffing and volunteer job roles and monitoring without liability protection is an issue that needs governmental protection for HCW's and licensing hospital
- Resources may be scarce

Next Steps/What Should Happen Next:

Our next steps are to continue with planning development and engage other citywide agencies such as Public Safety, Emergency management and private sector to share resources. We are working on legislation to provide HCW with liability protection during disasters and passing a funding bill to provide equipment and supplies to outfit the ISCU's.



Beth Israel Deaconess
Medical Center



A teaching hospital of
Harvard Medical School

THE SILVERMAN INSTITUTE
For Healthcare Quality and Safety

For More Information Contact
Meg Femino, Director, Emergency Management